

The **TERA Retractable System** provides the user with a designer cover that allows the outdoor area to be used all year round. The system offers a wind rating up to 117km/h and offers protection from the elements.

The system is custom manufactured using high grade 6063 extruded aluminium profiles and is finished with thermoset powder coating which provides superior overall performance for exterior applications. All fixings are high grade stainless steel to ensure extended life.

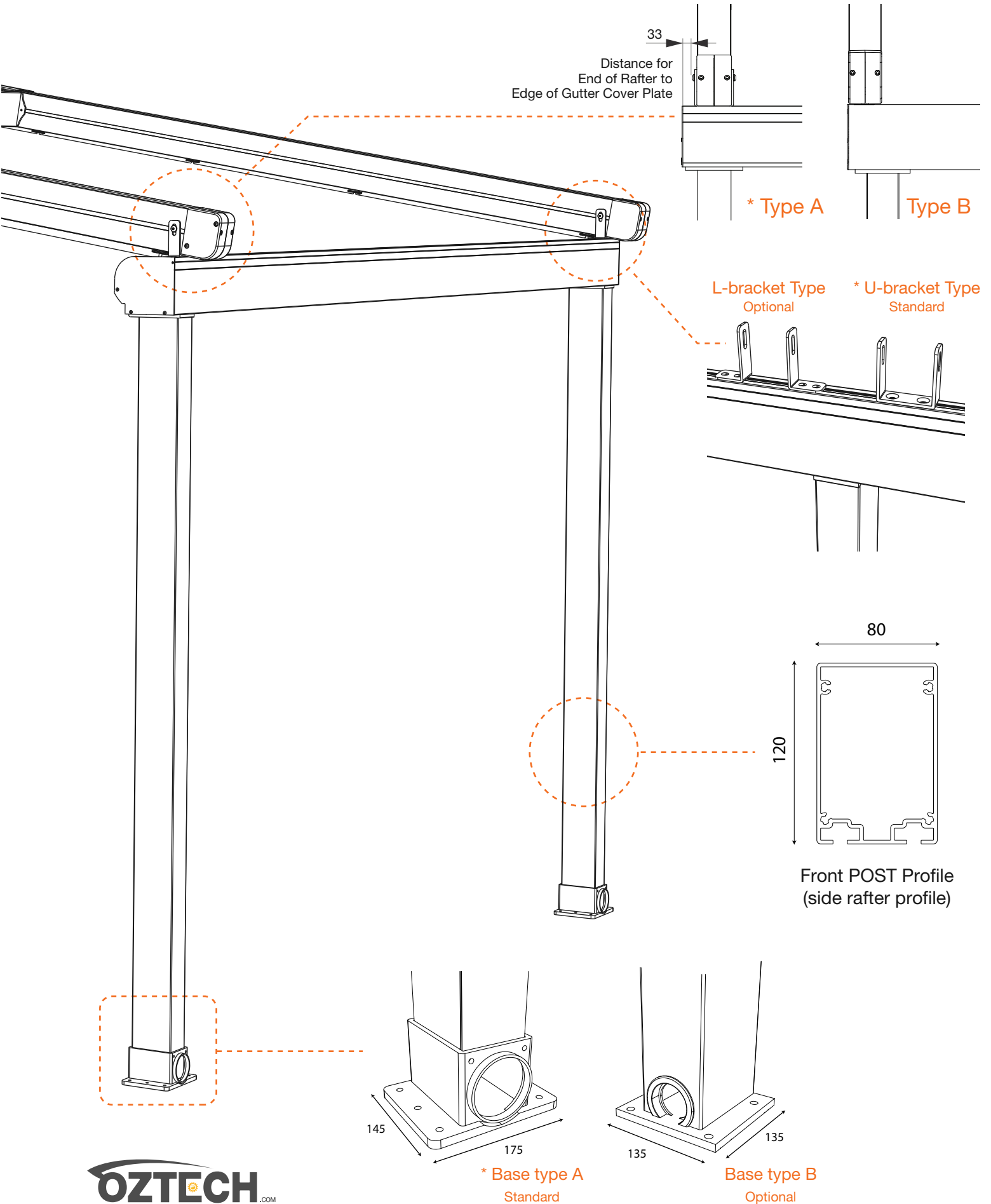

Single Module

Width. 2m > 5m

Single module with
single motor & 2 rafters

Projection. Max.7m

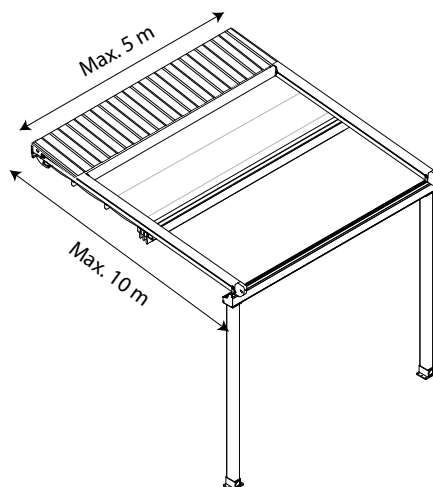

Double Module

Width. 5m > 9m

Double modules with
single motor & 3 rafters

Projection. Max.7m

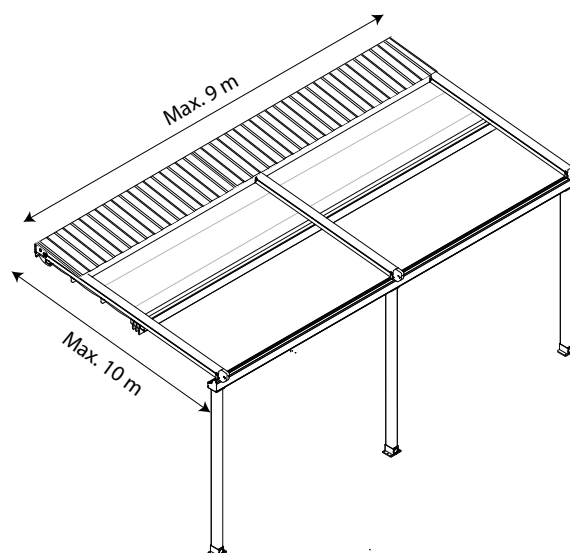

Triple Module

Width. 9m > 13m

Triple modules with
single motor & 4 rafters

Projection. Max.7m

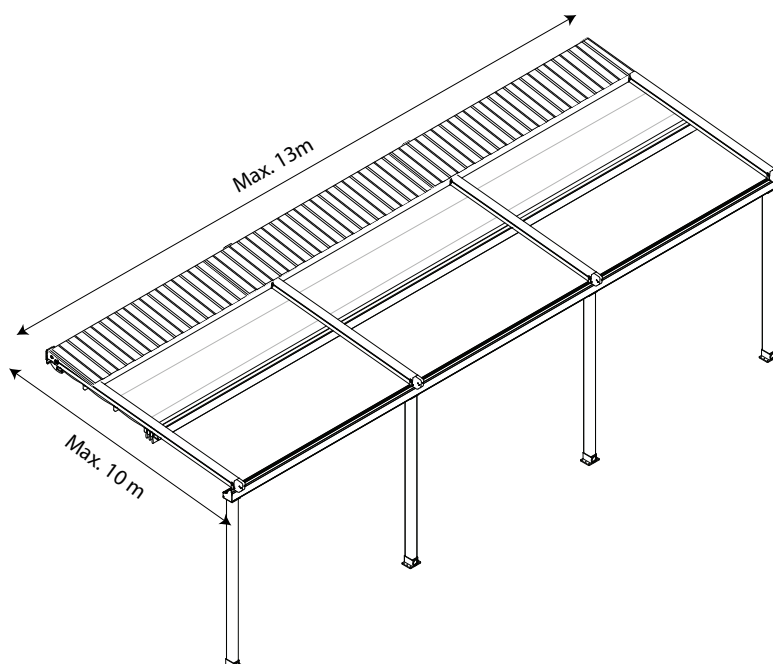

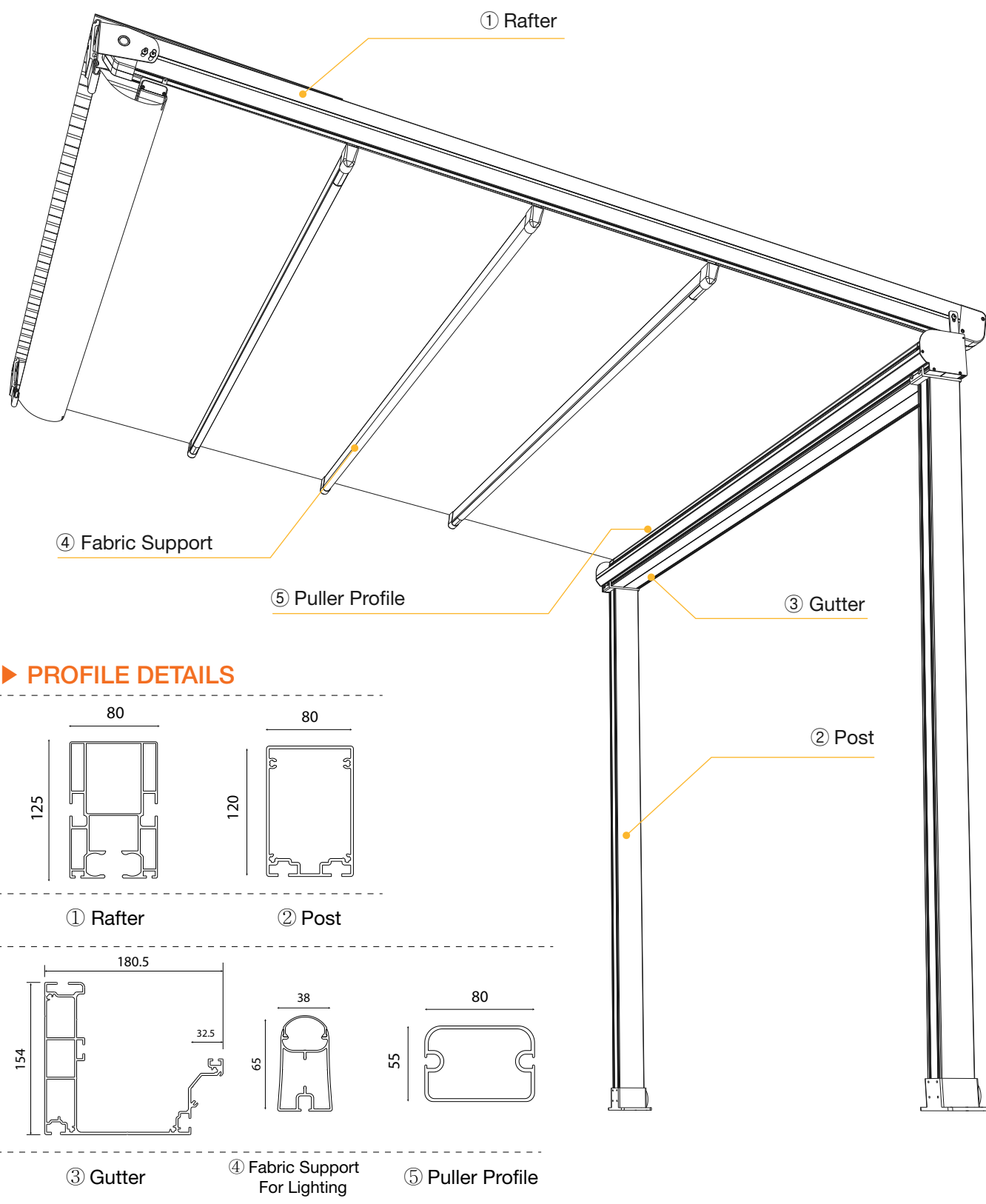

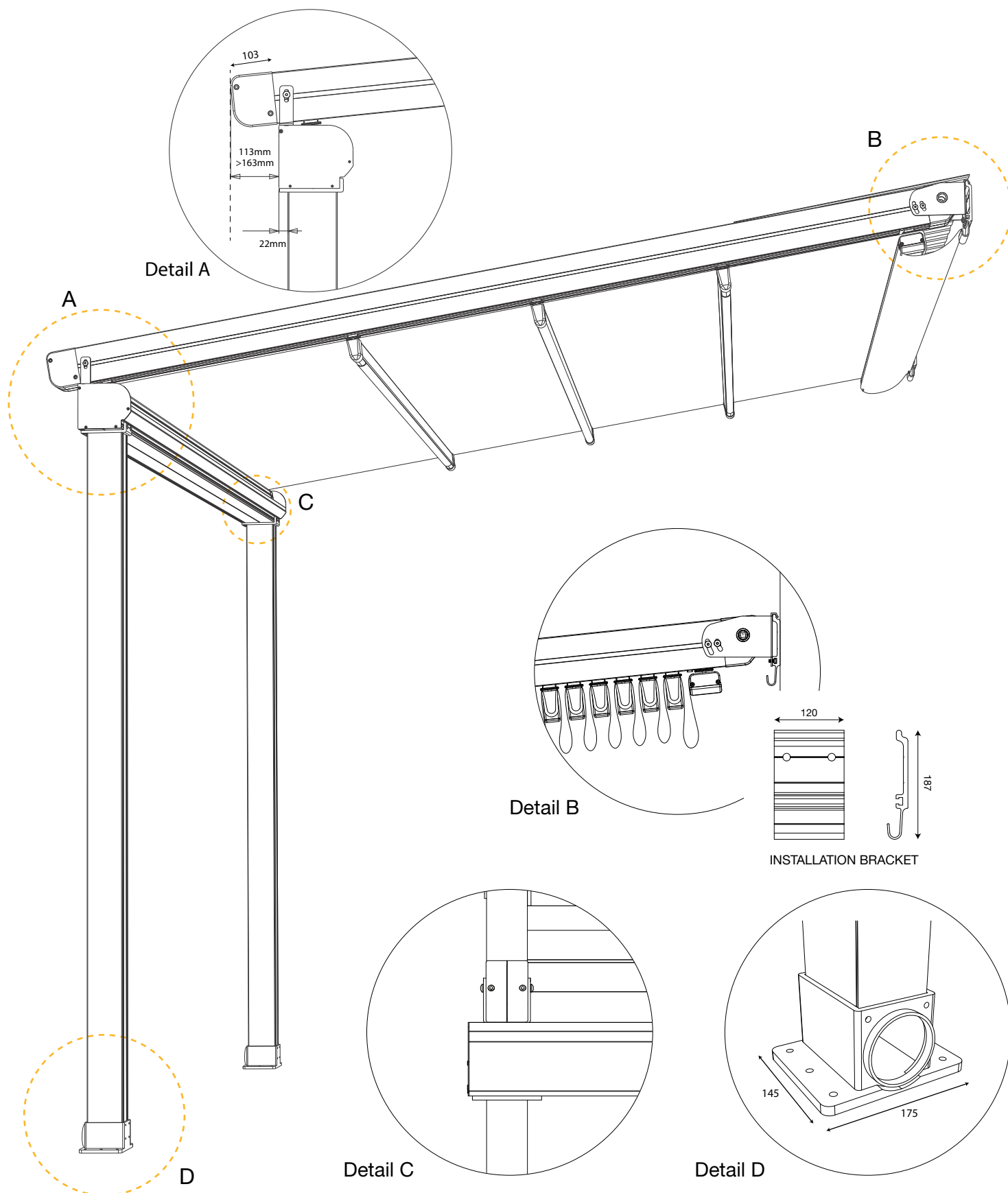

A. Width

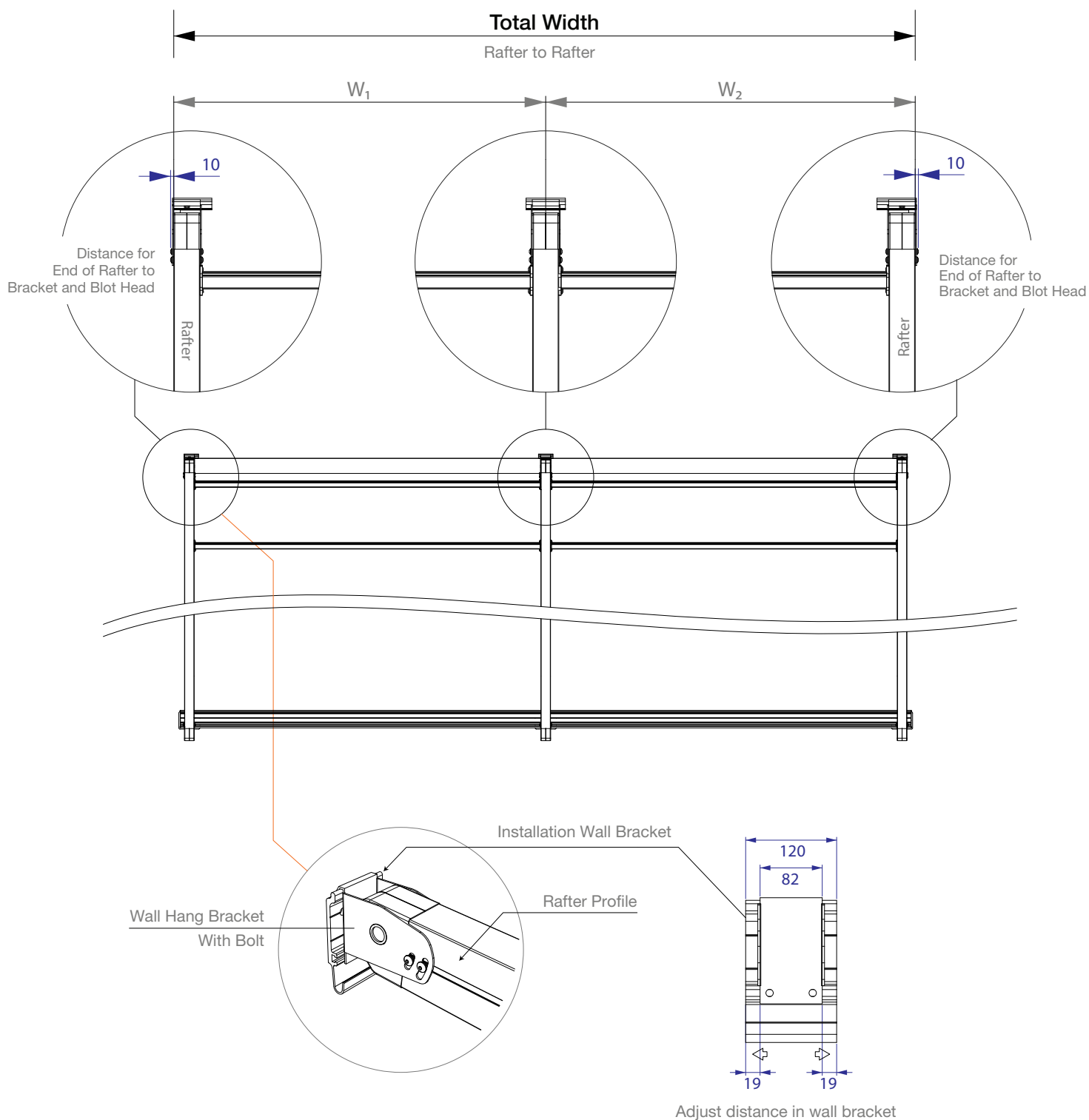
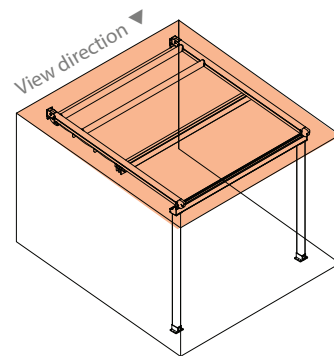

A. Width

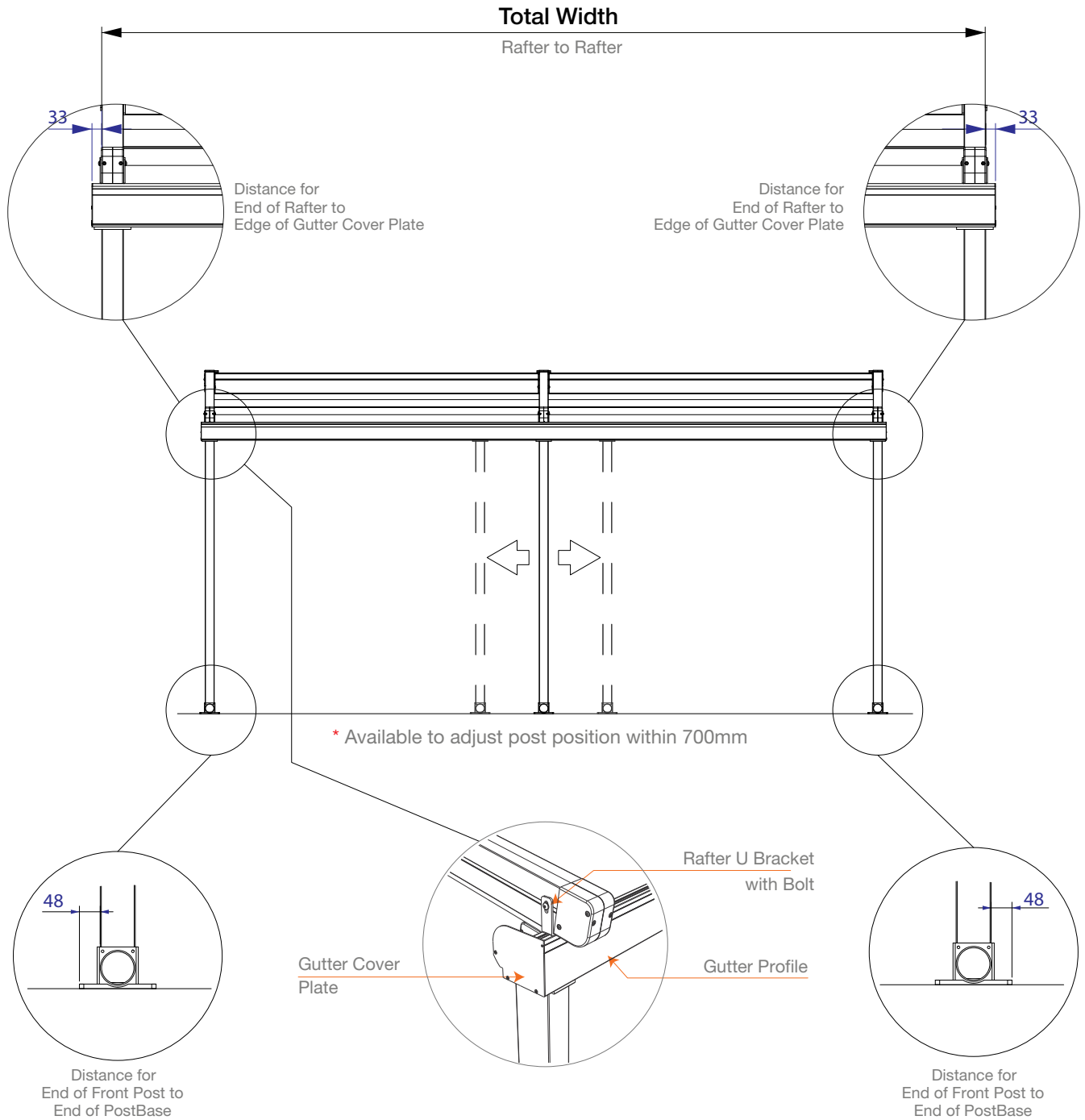
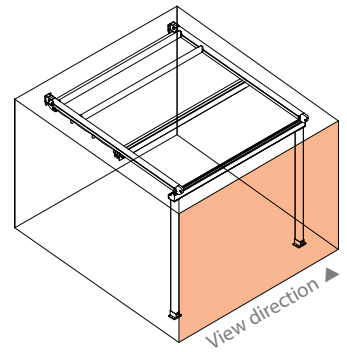

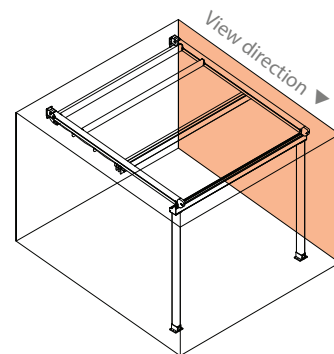

B. Projection & Height

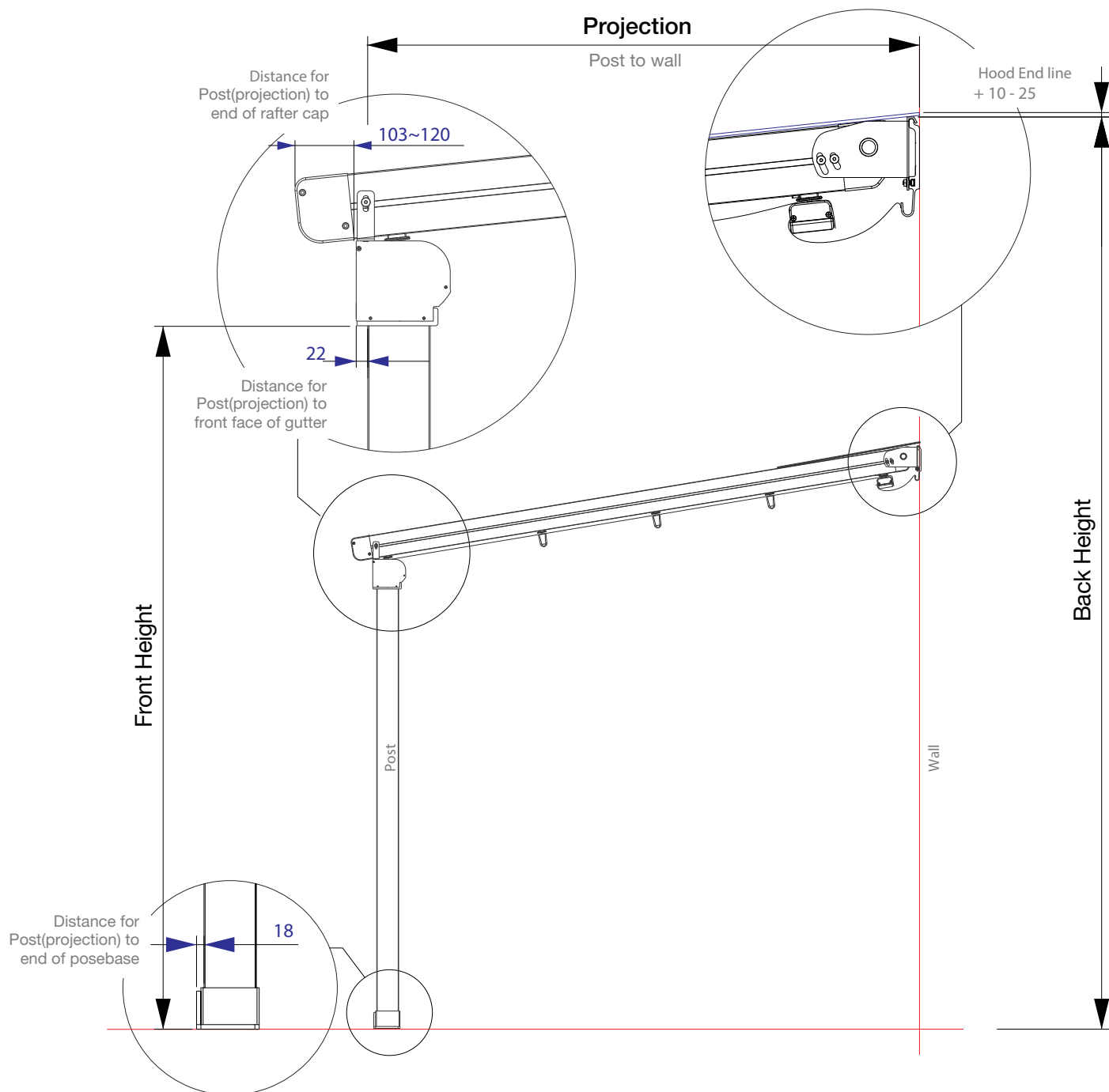

C. Angle

		Module Width													
Projection	TERA	2.0 M	fall	2.5 M	fall	3.0 M	fall	3.5 M	fall	4.0 M	fall	4.5 M	fall	5.0 M	fall
	2.0 M	2.7 °	379	3.5 °	407	4.5 °	442	5.0 °	460	5.7 °	485	6.0 °	495	7.0 °	531
	3.0 M	2.7 °	426	3.5 °	468	4.5 °	521	5.0 °	547	5.7 °	584	6.0 °	600	7.0 °	653
	4.0 M	2.7 °	474	3.5 °	530	4.5 °	600	5.0 °	635	5.7 °	684	6.0 °	705	7.0 °	776
	5.0 M	3.4 °	585	4.5 °	679	5.5 °	766	6.0 °	811	6.0 °	811	6.5 °	855	7.5 °	943
	6.0 M	3.4 °	645	4.5 °	757	5.5 °	863	6.0 °	916	6.0 °	916	7.5 °	1075	8.5 °	1182
	7.0 M	3.4 °	705	4.5 °	836	5.5 °	959	6.0 °	1021	7.0 °	1144	7.5 °	1207	8.5 °	1331

If lesser pitch than above table is required, please contact our staff for more details.

D. Option

1. Type

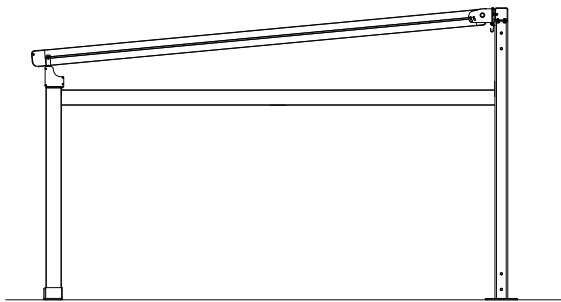

a. Freestanding

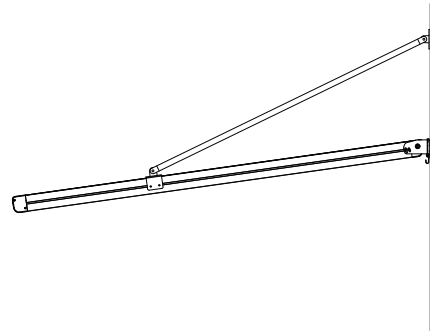

b. Cantilever

2. Rafter Bracket

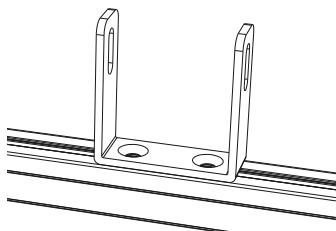

a. Rafter U brakcet

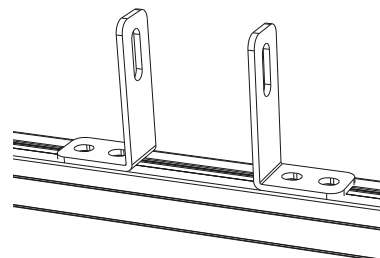

b. Rafter L brakcet

D. Option

3. LED Lighting system

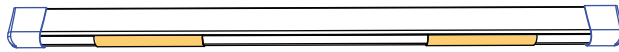

a. UNI LED

- LED Length - 265mm
- Quantity - 2 per module(available 3 per module)
- Layout - 1, 3, 5, 7, 9, 11, 13, 15, 17, 19 middle line
- ※ Please contact us if you want to customize LED layout



b. MAXI LED

- LED Length - 600 ~ 5,400mm
- Quantity - 1 per module
- Layout - 1, 4, 7, 10, 13, 16, 19, 22 middle line
- ※ Please contact us if you want to customize LED layout

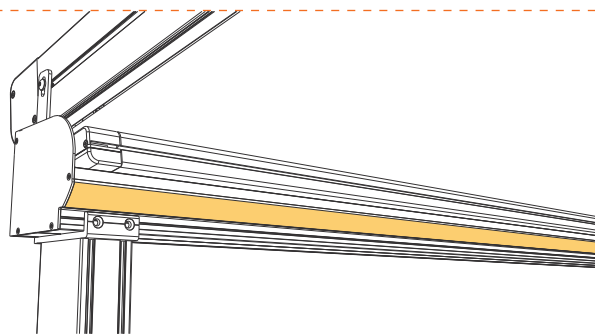

c. GUTER LED

- LED Length = Gutter Length
- Quantity - 1 line(Harbour - 2)

★ Please choose one lighting system

- | | |
|------------------|------------------------|
| 1) UNILED ONLY | 3) UNILED + GUTTER LED |
| 2) MAXI LED ONLY | 4) MAXI + GUTTER LED |

♣ LED color - natural(4000~4500k)

♣ Available dimming function